

VIA Indoor 2023 - Instruction in brief

VIA Indoor is a very special indoor sprint race that takes place on Sunday 19 March 2023.

We are looking forward to an exciting and challenging event on Sunday.

Time	Sunday, 19 th of March 2023
Event area	The five lower floors of VIA University College in Horsens.
Parking	VIA's parking ground. Entry from Emil Møllers Gade.
Event Centre	The central hall, first floor. VIA Universit, lege. Entry from yellow main entrance.
Event Office	Just inside the hall on your left side. Opens at 10.00 a.m.
Toilets	See map
Rented chips	To be collected at the Event Office.
Start	See map
Starting procedure	<p>Free start (put & run) from 11.00 a.m. to 1.00 p.m.</p> <p>You may collect a set of control descriptions if you bring own holder.</p> <p>Remember to clear and check your SI electronic chip.</p> <p>Runners in the class Open 1 go into the left lane.</p> <p>All other runners go into the right lane and proceed to box 2. Enter the box when space allows.</p> <p>You pick your map from the box, marked with your course/class and proceed to the starting line.</p> <p>You start when the starter allows you. Remember to punch the start control. Your time starts when you punch.</p> <p>If you need help, call on one of the assistants (3 and 4).</p>

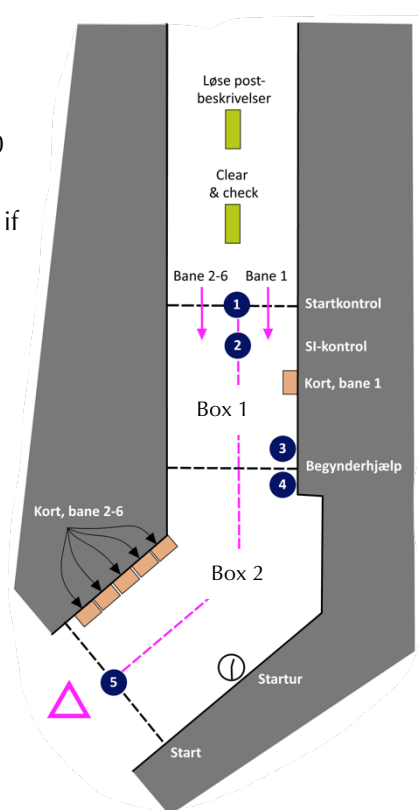
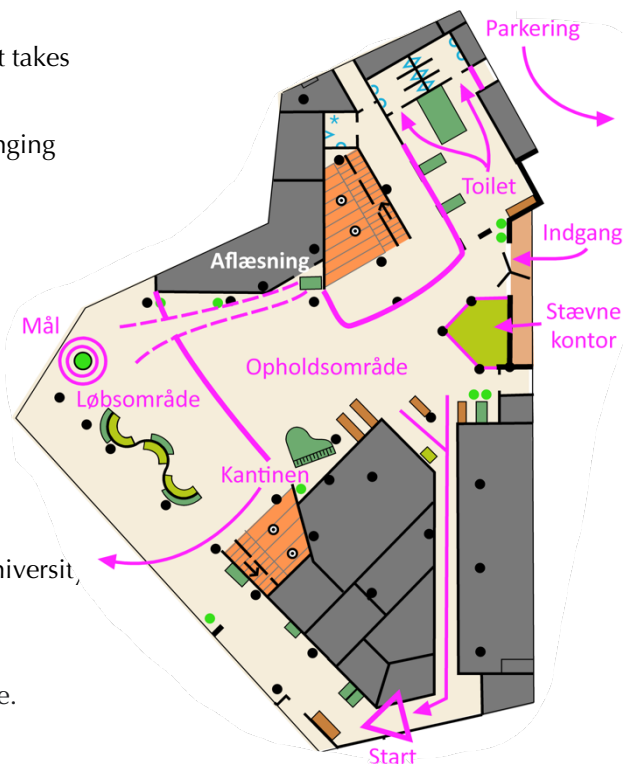

Shoes Only flat shoes without spikes etc. are allowed – and the shoes must be clean.

Map VIA University College, scale 1:750, drawn early spring in 2023.
All maps are printed on A3. A copy of the map may be seen at the Event Office.
Control descriptions are on the map.

Map turn-over The course Open 4 has map turn-over at control 13, Open 5 at control 15, and Open 6 at control 18.

Controls The controls are marked with triangular flags, size 15x15 cm. Very close to the control flag the SI punching device is found.
It is your own responsibility to get a signal (sound or light) to confirm your punch.

Courses	Course	# floor changes up	# Controls	Winning time
	Open 1	3	14	12 min
	Open 2	5	13	15 min
	Open 3	10	18	18 min
	Open 4	18	23	20 min
	Open 5	23	28	22 min
	Open 6	27	33	25 min

Results Live results will be published continuously on LiveResults. Link og QR-kode:
<https://liveresultat.orientering.se/followfull.php?comp=25380&lang=en>



Results will be available after the event at the Horsens OK website.
You may find all courses at <https://o-track.dk> after the event.

Event Team
Event Director: Erik Nielsen, Horsens OK
E-mail: horsensok.indoor@gmail.com
Mobile: 2069 2437.
Event Controller: Peer Straarup, Horsens OK
Course Setters: Allan Skoubo & Thomas Emil Jensen, Horsens OK
Referee: Aase Thyssen, Horsens OK
Mappers: Troels Jensen & Erik Nielsen, Horsens OK



INSERO HORSENS

Rules for indoor orienteering

Areas out of bounds

Areas out of bounds are marked with a dark-grey or purple colour.

It is strictly forbidden to enter areas out of bounds and you will be disqualified in case of violation.

Cordon off areas

Red-white cordon off tapes must not be passed.

Doors

Doors drawn open on the map will be open and may be passed.

Doors drawn closed are closed and cannot be passed.

Toilets

You are not allowed to use the toilets in the competition area. Use the toilets that are marked from the Event Centre.

Keep right

To avoid collisions, it is obligatory to keep right. Be aware of narrow corners and especially at the stairs there is a risk for collision with other runners.

Be careful and keep right

Furniture

You are not allowed to jump over furniture. Run around and keep your feet on the ground all the time.

Look up

There are a lot of glass windows and glass doors at VIA University College, so always remember to look up while you run.

Should it happen that something breaks during the competition, notify the Event Office as soon as possible. Remember that you are the one responsible... and your insurance company must pay if something breaks.



About the map

Walls and floors A thick black line marks an outer wall or a closed outer door in the building.
A black line marks an interior wall or a closed door. Closed doors must not be passed or opened!
Doors marked with red and white tape and/or a sign that reads "Må ikke åbnes", must not be passed.

Restricted areas A restricted area is either marked with a dark gray or purple fill color.
White areas are "out of bounds" and typically show places where it is absolutely impossible to run.
Indoors you may only run where there is a light yellow "floor colour", and outdoors only where there is a brown floor colour.

Furniture Tables are drawn with dark green fill colour, seating furniture, i.e. sofas and arm-chairs, with an olive green fill colour, and shelves and cabinets with a brown fill colour. Chairs are not included. No furniture may be jumped over or run under.
Some movable furniture in the common areas, especially on the 1st, 2nd and 3rd floors, cannot be assured to be where the map shows. VIA is a living organism, and the furniture is moved around daily by the students.
Controls are placed at objects that are drawn correctly.

Buildings VIA University College consists of 3 buildings with 4 floors, 5 floors and 16 floors.
The buildings are designated with the letters A, B and C.
On the map, the floors are designated with the combination of letter and floor, i.e. C04 denotes the 4th floor in building C.

Example:



Stairs

All stairs have arrows that shows the direction.

A black arrow on an orange background indicates an upward staircase from the landing you are standing on. The above standing has the same orange colour.

A red arrow on a light yellow "floor colour" indicates a downward staircase from the landing you are standing on. The standing below is (for good reasons) not drawn on the map.

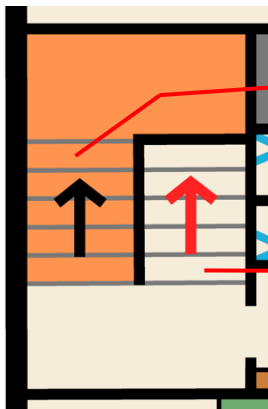

Other symbols

♿ / ♿ / ♿ / * Toilet / urinal / sink / shower

● / ● Big plant / potted plant

■ / ● / ● Pillars / sculpture

Meridians

No meridians are found on the map. North is slightly turned to the left.

If you want to use a compass, use the north arrow on the map, which points in the right direction.

Control descriptions

The control descriptions are adapted to the indoor event. Most signatures are self-explanatory.

Symbol	Name	Used at VIA indoor
♿	3.3 Vandhul	Toilet
🌳	4.9 Markant træ	Big or small plant
🧱	5.8 Mur	Wall
🍽️	5.21 Overdækket område	Table
🛋️	6.3 Sofa*	Prominent sofa
🗄️	6.4 Skab*	Cabinet
🏛️	6.5 Søjle*	Pillar
* not IOF-standard (made for the purpose)		

Control numbers

Control numbers are both printed on the map and to be collected separately before start.