



## VIA Indoor Sprint 2024 - Instruction in brief

VIA Indoor is a very special indoor sprint race that takes place on Wednesday 27<sup>th</sup> of March 2023.

We are looking forward to an exciting and challenging event on Wednesday.

- Time** Wednesday, 27<sup>th</sup> of March 2023
- Event area** The five lower floors of VIA University College in Horsens.
- Parking** VIA's parking ground. Only parking spaces marked VIA are free of charge.



Entry from Emil Møllers Gade.

- Event Centre** The central hall, first floor. VIA University Col. Entry from yellow main entrance – East side.

- Event Office** Just inside the hall on your left side. Opens at 4.00 p.m.

- Toilets** See map

- Rented chips** To be collected at the Event Office.

- Start** See map

- Starting procedure** Free start (put & run) from 4.30 p.m. to 7.00 p.m.

You may collect a set of control descriptions if you bring your own holder.

Remember to clear and check your SI electronic chip before start.

Runners in the class Open 1 go into the right lane.

All other runners go into the left lane and proceed to box 2. Enter the box when space allows.

You pick your map from the box, marked with your course/class and proceed to the starting line.

You start when the starter allows you. Remember to punch the start control. Your time starts when you punch.

If you need help, call on one of the assistants (3 and 4).

- Shoes** Only flat shoes without spikes etc. are allowed – and the shoes must be clean.

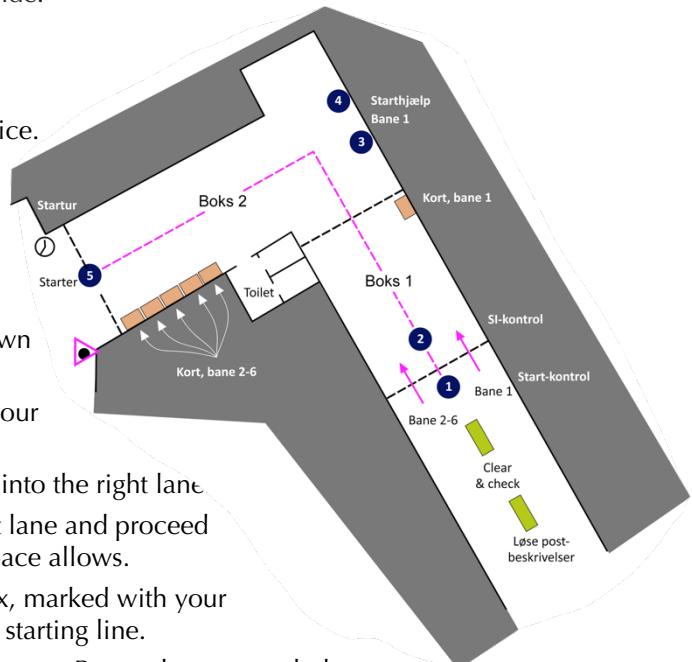
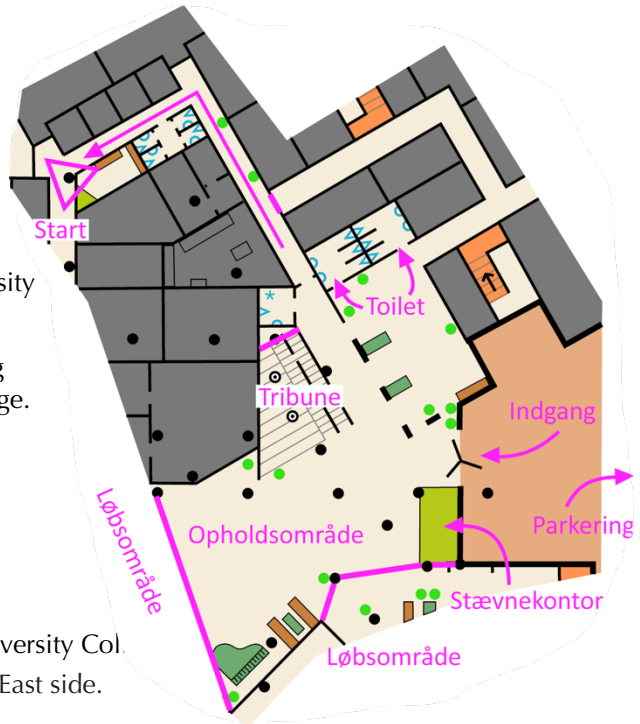

**Map** VIA University College, scale 1:750, revised and updated in March 2024.  
All maps are printed on A3. A copy of the map may be seen at the Event Office.  
Control descriptions are on the map.

**Map turn-over** Course 4 has map turn-over at control 12, Course 5 at control 12, and Course 6 at control 18.

**Controls** The controls are marked with triangular flags, size 15x15 cm. Very close to the control flag the SI punching device is found.  
It is your own responsibility to get a signal (sound or light) to confirm your punch.

Course	Classes	# floor changes	# Controls	Winning time
1	W-12, M-12, Open 1	2	19	12 min
2	W-14, M-14, Open 2	6	17	15 min
3	W60+, M60+, Open 3	10	16	25 min
4	W-16, W45+, Open 4	17	23	25 min
5	M-16, M45+, W21, Open 5	28	22	30 min
6	M21, Open 6	34	32	35 min

**Results** Live results will be published continuously on <https://liveresultat.orientering.se>  
Results will be available after the event at the Horsens OK website.

**Event Team** Event Director: Erik Nielsen, Horsens OK  
E-mail: [horsensok.indoor@gmail.com](mailto:horsensok.indoor@gmail.com)  
Mobile: 2069 2437.  
Event Controller: Peer Straarup, Horsens OK  
Course Setter: Thomas Emil Jensen, Horsens OK  
Referee: Aase Thyssen, Horsens OK  
Mappers: Erik Nielsen, assisted by Troels Jensen, Horsens OK

# Rules for indoor orienteering

---

**Areas out of bounds**

Areas out of bounds are marked with a dark-grey or purple colour.

It is strictly forbidden to enter areas out of bound and you will be disqualified in case of violation.

**Cordon off areas**

Red-white cordon off tapes must not be passed.

**Doors**

Doors drawn open on the map will be open and may be passed.

Doors drawn closed are closed and cannot be passed.

**Toilets**

You are not allowed to use the toilets in the competition area. Use the toilets that are marked from the Event Centre.

**Keep right**

To avoid collisions, it is obligatory to keep right. Be aware of narrow corners and especially at the stairs there is a risk for collision with other runners.

Be careful and keep right

**Furniture**

You are not allowed to jump over furniture. Run around and keep your feet on the ground all the time.

**Look up**

There are a lot of glass windows and glass doors at VIA University College, so always remember to look up while you run.

Should it happen that something breaks during the competition, notify the Event Office as soon as possible. Remember that you are the one responsible... and your insurance company must pay if something breaks.



# About the map

**Walls and floors** A thick black line marks an outer wall or a closed outer door in the building.  
A black line marks an interior wall or a closed door. Closed doors must not be passed or opened!  
Doors marked with red and white tape and/or a sign that reads "Må ikke åbnes", must not be passed.

**Restricted areas** A restricted area is either marked with a dark gray or purple fill color.  
White areas are "out of bounds" and typically show places where it is absolutely impossible to run.  
Indoors you may only run where there is a light yellow "floor colour", and outdoors only where there is a brown floor colour.

**Furniture** Tables are drawn with dark green fill colour, seating furniture, i.e. sofas and arm-chairs, with an olive-green fill colour, and shelves and cabinets with a brown fill colour. Chairs are not included. No furniture may be jumped over or run under.  
Some movable furniture in the common areas, especially on the 1st, 2nd and 3rd floors, cannot be assured to be where the map shows. VIA is a living organism, and the furniture is moved around daily by the students.  
Controls are placed at objects that are drawn correctly.

**Buildings** VIA University College consists of 3 buildings with 4 floors, 5 floors and 16 floors.  
The buildings are designated with the letters A, B and C.  
On the map, the floors are designated with the combination of letter and floor, i.e. C04 denotes the 4th floor in building C.

**Example:**



**Stairs**

All stairs have arrows that shows the direction.

A black arrow on an orange background indicates an upward staircase from the landing you are standing on. The above standing has the same orange colour.

A red arrow on a light yellow "floor colour" indicates a downward staircase from the landing you are standing on. The standing below is (for good reasons) not drawn on the map.

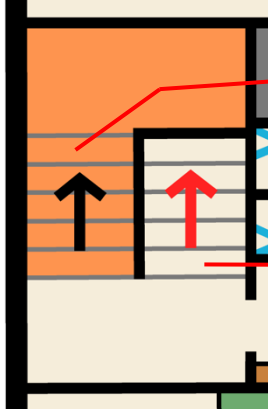

**Other symbols**

v/∩/∪/\* Toilet / urinal / sink / shower

● / • Big plant / potted plant

■ / ● / ○ Pillars / sculpture

**Meridians**

No meridians are found on the map. North is slightly turned to the left.

If you want to use a compass, use the north arrow on the map, which points in the right direction.

**Control descriptions**

The control descriptions are adapted to the indoor event. Most signatures are self-explanatory.

Symbol	Name	Used at VIA indoor
	3.3 Waterhole	Toilet
	4.9 Prominent tree	Big or small plant
	5.8 Wall	Wall
	5.21 Canopy	Table
	6.3 Prominent sofa*	Prominent sofa
	6.4 Cabinet*	Cabinet
	6.5 Pillar*	Pillar
* not IOF-standard (made for the purpose)		

**Control numbers**

Control numbers are both printed on the map and to be collected separately before start.